

**TYPICAL BARGE DETAIL - CROSS SECTION**

**SHINGLE & SHAKE**  
SHINGLE ROOFING INSTALLERS

Shingle and Shake Ltd  
PO Box 101 760, North Shore Auckland  
16A Parkhead Place, Rosedale, North Shore  
Auckland, New Zealand  
Ph: 64 9 270 2690  
Web: [www.shingleandshake.co.nz](http://www.shingleandshake.co.nz)

**BARGE-CROSS SECTION**

Project number	<b>001</b>
Date	
Drawn by	
Checked by	
Scale	1 : 5

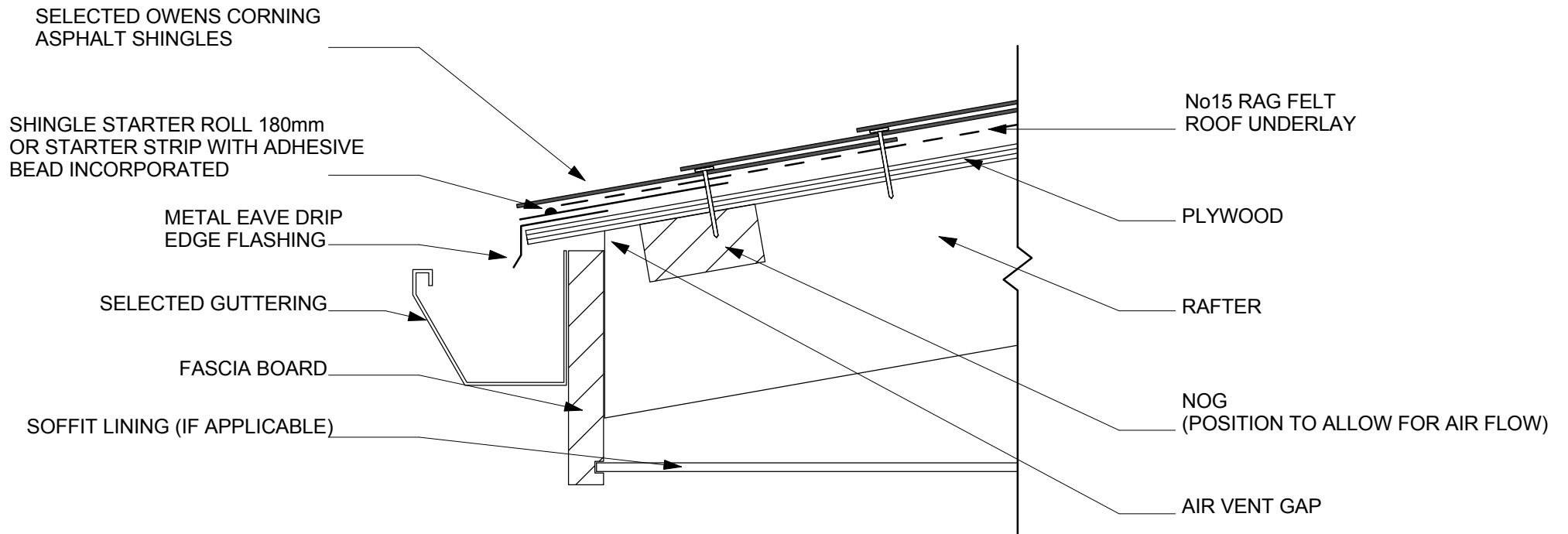

**TYPICAL EAVE DETAIL - CROSS SECTION**

**SHINGLE & SHAKE**  
SHINGLE ROOFING INSTALLERS

Shingle and Shake Ltd  
PO Box 101 760, North Shore Auckland  
16A Parkhead Place, Rosedale, North Shore  
Auckland, New Zealand  
Ph: 64 9 270 2690  
Web: [www.shingleandshake.co.nz](http://www.shingleandshake.co.nz)

**EAVE-CROSS SECTION**

Project number	<b>003</b>
Date	
Drawn by	
Checked by	
Scale	1 : 5

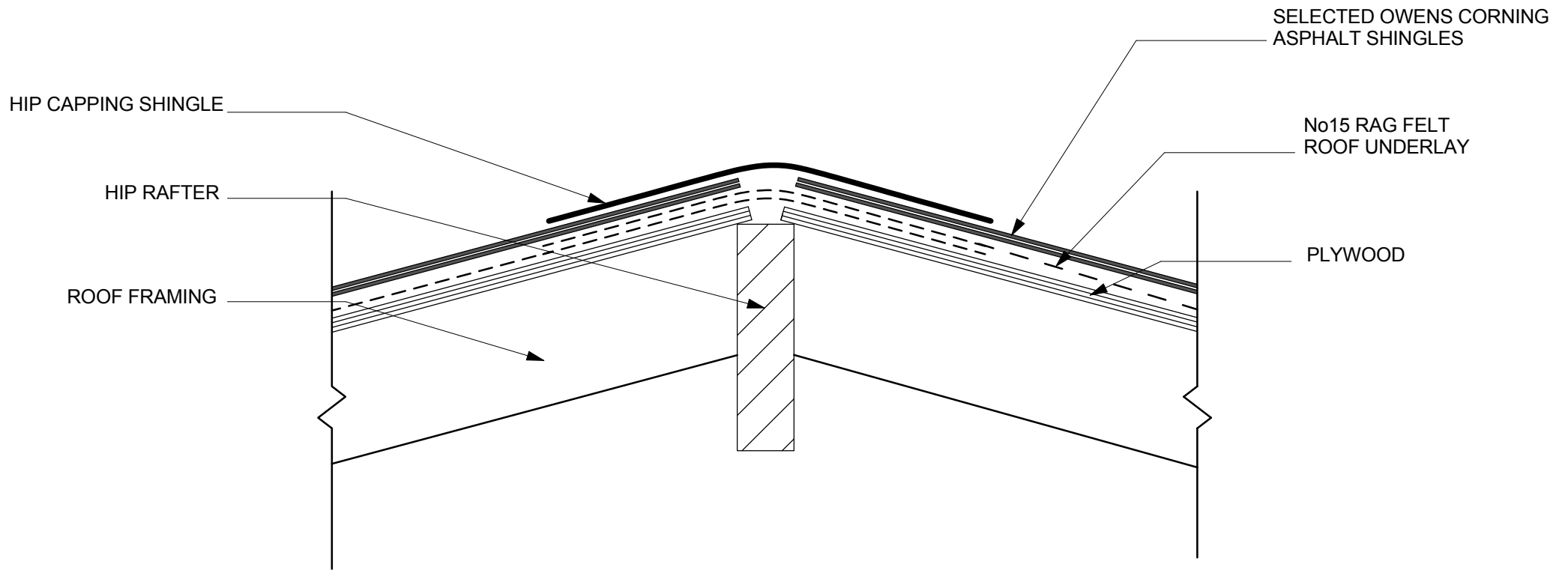

**TYPICAL HIP DETAIL- CROSS SECTION**

**SHINGLE & SHAKE**  
SHINGLE ROOFING INSTALLERS

Shingle and Shake Ltd  
PO Box 101 760, North Shore Auckland  
16A Parkhead Place, Rosedale, North Shore  
Auckland, New Zealand  
Ph: 64 9 270 2690  
Web: [www.shingleandshake.co.nz](http://www.shingleandshake.co.nz)

**HIP-CROSS SECTION**

Project number	<b>005</b>
Date	
Drawn by	
Checked by	
Scale	1 : 5

RIDGE CAPPING SHINGLE

NOGS  
(POSITIONED TO ALLOW AIR FLOW)

ROOF FRAMING

SOUTH PACIFIC SHINGLES  
RIDGE VENT

SELECTED OWENS CORNING  
ASPHALT SHINGLES

No15 RAG FELT  
ROOF UNDERLAY

PLYWOOD

AIR VENT GAP

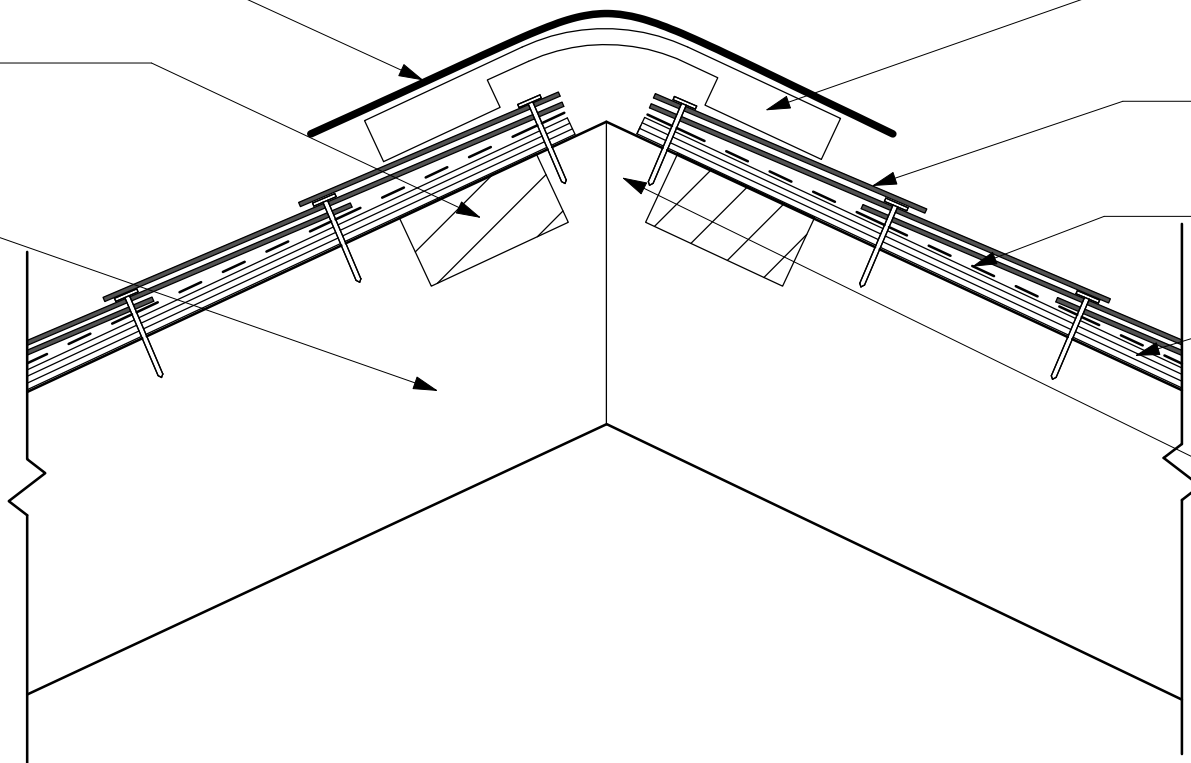

**TYPICAL RIDGE DETAIL- CROSS SECTION**

**SHINGLE & SHAKE**  
SHINGLE ROOFING INSTALLERS

Shingle and Shake Ltd  
PO Box 101 760, North Shore Auckland  
16A Parkhead Place, Rosedale, North Shore  
Auckland, New Zealand  
Ph: 64 9 270 2690  
Web: [www.shingleandshake.co.nz](http://www.shingleandshake.co.nz)

RIDGE-CROSS SECTION	
Project number	006
Date	
Drawn by	
Checked by	
Scale	1 : 5

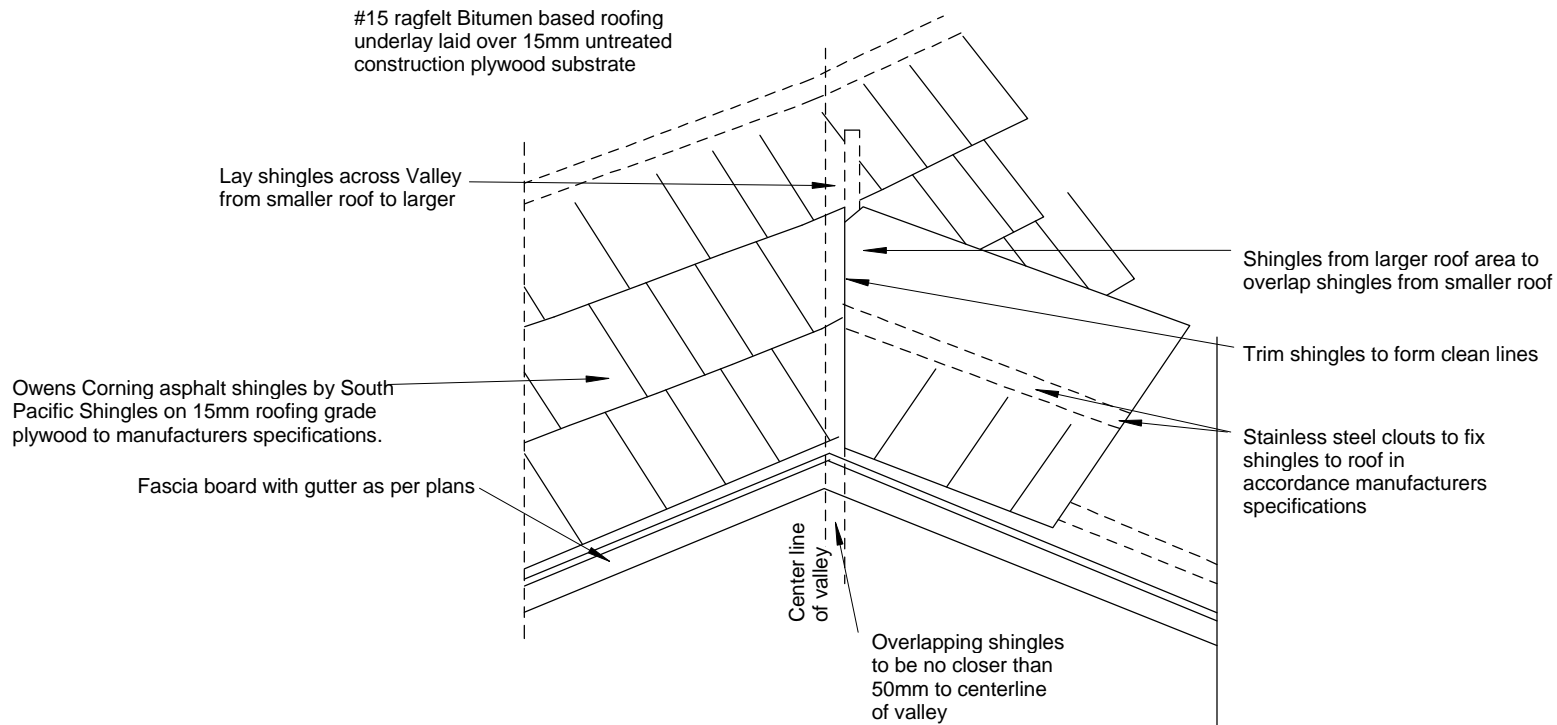

**Valley Cladding Detail N.T.S**

**SHINGLE & SHAKE**  
SHINGLE ROOFING INSTALLERS

Shingle and Shake Ltd  
PO Box 101 760, North Shore Auckland  
16A Parkhead Place, Rosedale, North Shore  
Auckland, New Zealand  
Ph: 64 9 270 2690  
Web: www.shingleandshake.co.nz

**Valley Cladding Detail N.T.S**

Project number	<b>001</b>
Date	
Drawn by	
Checked by	
Scale	1 : 5

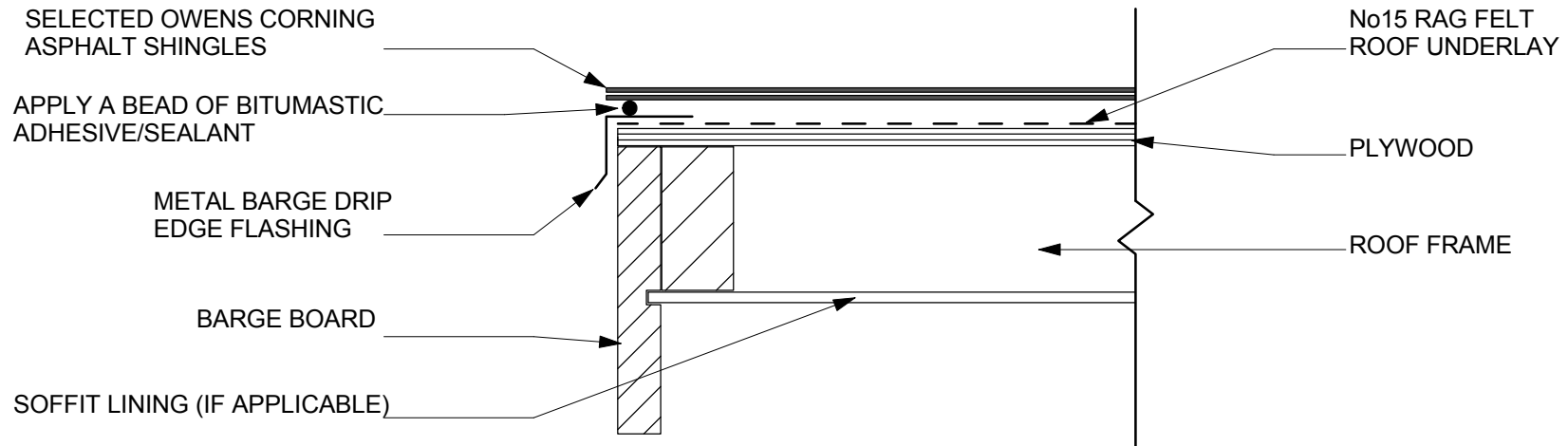

**TYPICAL BARGE DETAIL - CROSS SECTION**

**SHINGLE & SHAKE**  
SHINGLE ROOFING INSTALLERS

Shingle and Shake Ltd  
PO Box 101 760, North Shore Auckland  
16A Parkhead Place, Rosedale, North Shore  
Auckland, New Zealand  
Ph: 64 9 270 2690  
Web: [www.shingleandshake.co.nz](http://www.shingleandshake.co.nz)

**BARGE-CROSS SECTION**

Project number	<b>001</b>
Date	
Drawn by	
Checked by	
Scale	1 : 5

SOUTH PACIFIC SHINGLES RIDGE VENT  
(IN ROOF VENTS ALSO ACCEPTABLE)

SELECTED OWENS CORNING  
ASPHALT SHINGLES

No15 RAG FELT  
ROOF UNDERLAY

PLYWOOD

ROOF FRAME

COLOURSTEEL OR COPPER  
RIDGE FLASHING

AIR VENT GAP

BARGE BOARD

NOG  
(POSITION TO ALLOW AIR FLOW)

SELECTED CLADDING

WALL FRAME

**TYPICAL ROOF/WALL RIDGE DETAIL - CROSS SECTION**

**SHINGLE & SHAKE**  
SHINGLE ROOFING INSTALLERS

Shingle and Shake Ltd  
PO Box 101 760, North Shore Auckland  
16A Parkhead Place, Rosedale, North Shore  
Auckland, New Zealand  
Ph: 64 9 270 2690  
Web: www.shingleandshake.co.nz

**ROOF/WALL RIDGE-CROSS SECTION**

Project number	<b>004</b>
Date	
Drawn by	
Checked by	
Scale	1 : 5

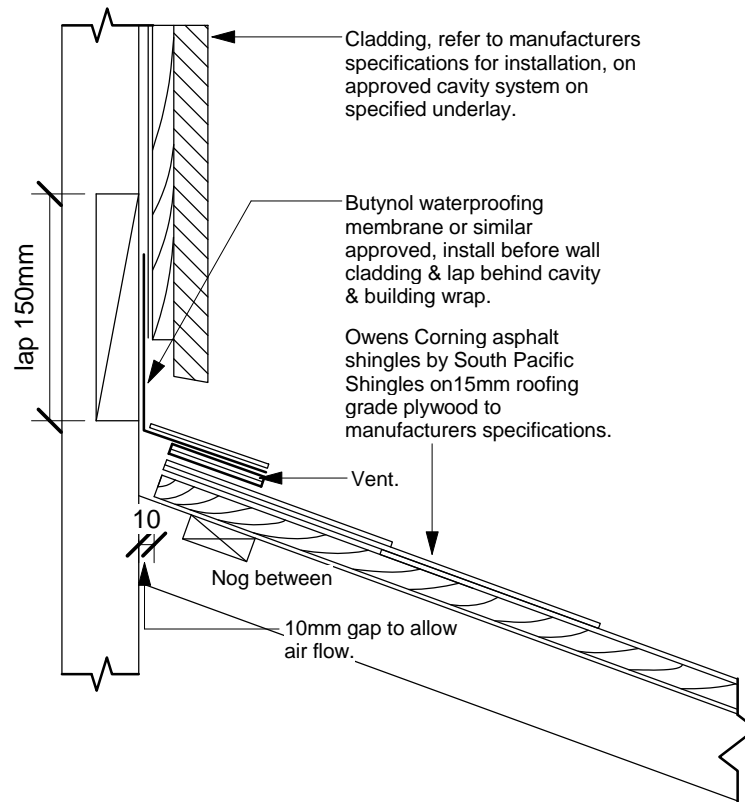

**Typical Owens Corning Shingle  
Vented Apron Flashing - Roof to Wall**

**SHINGLE & SHAKE**  
SHINGLE ROOFING INSTALLERS

Shingle and Shake Ltd  
PO Box 101 760, North Shore Auckland  
16A Parkhead Place, Rosedale, North Shore  
Auckland, New Zealand  
Ph: 64 9 270 2690  
Web: [www.shingleandshake.co.nz](http://www.shingleandshake.co.nz)

Vented Apron Flashing - Roof to wall

Project number	001
Date	
Drawn by	
Checked by	
Scale	1 : 5



Cladding, refer to manufacturers specifications for installation, on approved cavity system on specified underlay.

Butynol waterproofing membrane or similar approved, lap behind cladding and shingles.

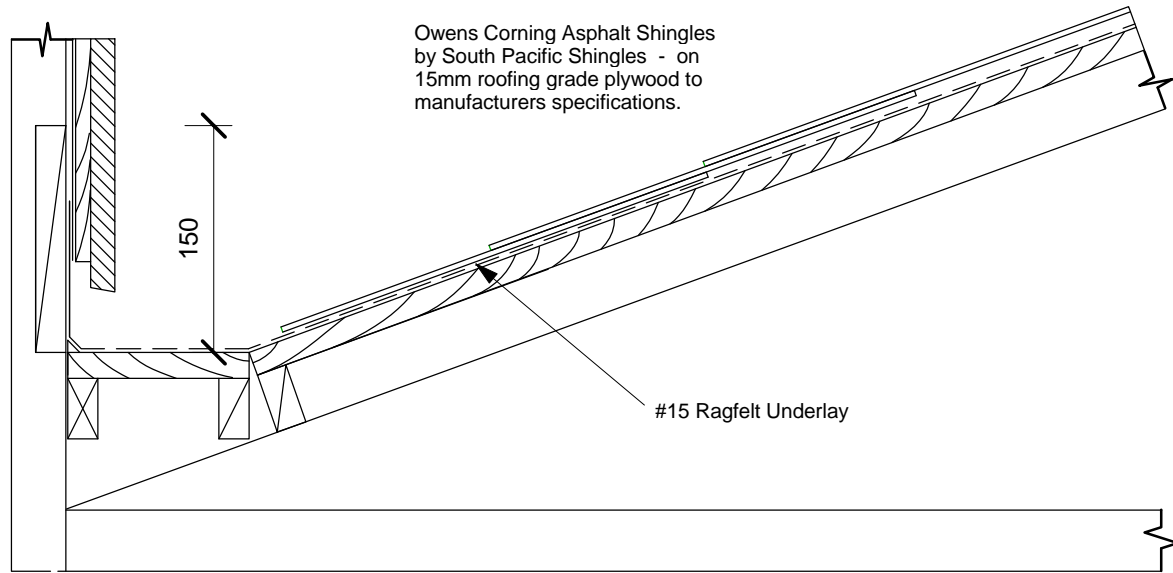

Owens Corning Asphalt Shingles by South Pacific Shingles - on 15mm roofing grade plywood to manufacturers specifications.

#15 Ragfelt Underlay

### Owens Corning Shingles Chimney Flashing

**SHINGLE & SHAKE**  
SHINGLE ROOFING INSTALLERS

Shingle and Shake Ltd  
PO Box 101 760, North Shore Auckland  
16A Parkhead Place, Rosedale, North Shore  
Auckland, New Zealand  
Ph: 64 9 270 2690  
Web: [www.shingleandshake.co.nz](http://www.shingleandshake.co.nz)

owens corning shingles chimney flashing

Project number	001
Date	
Drawn by	
Checked by	
Scale	1 : 5

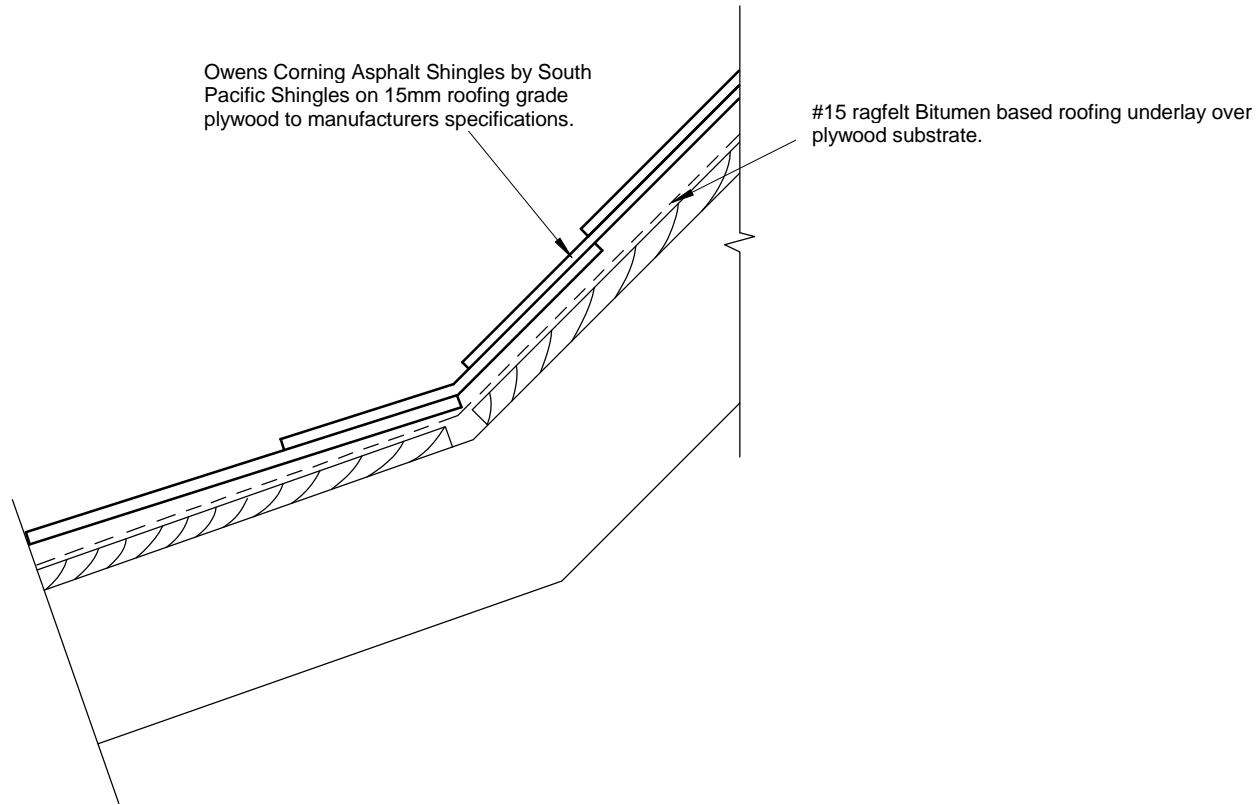

**Flashing Detail for Change in Roof Pitch**

**SHINGLE & SHAKE**  
SHINGLE ROOFING INSTALLERS

Shingle and Shake Ltd  
PO Box 101 760, North Shore Auckland  
16A Parkhead Place, Rosedale, North Shore  
Auckland, New Zealand  
Ph: 64 9 270 2690  
Web: [www.shingleandshake.co.nz](http://www.shingleandshake.co.nz)

Flashing detail for change in roof pitch

Project number	001
Date	
Drawn by	
Checked by	
Scale	1 : 5

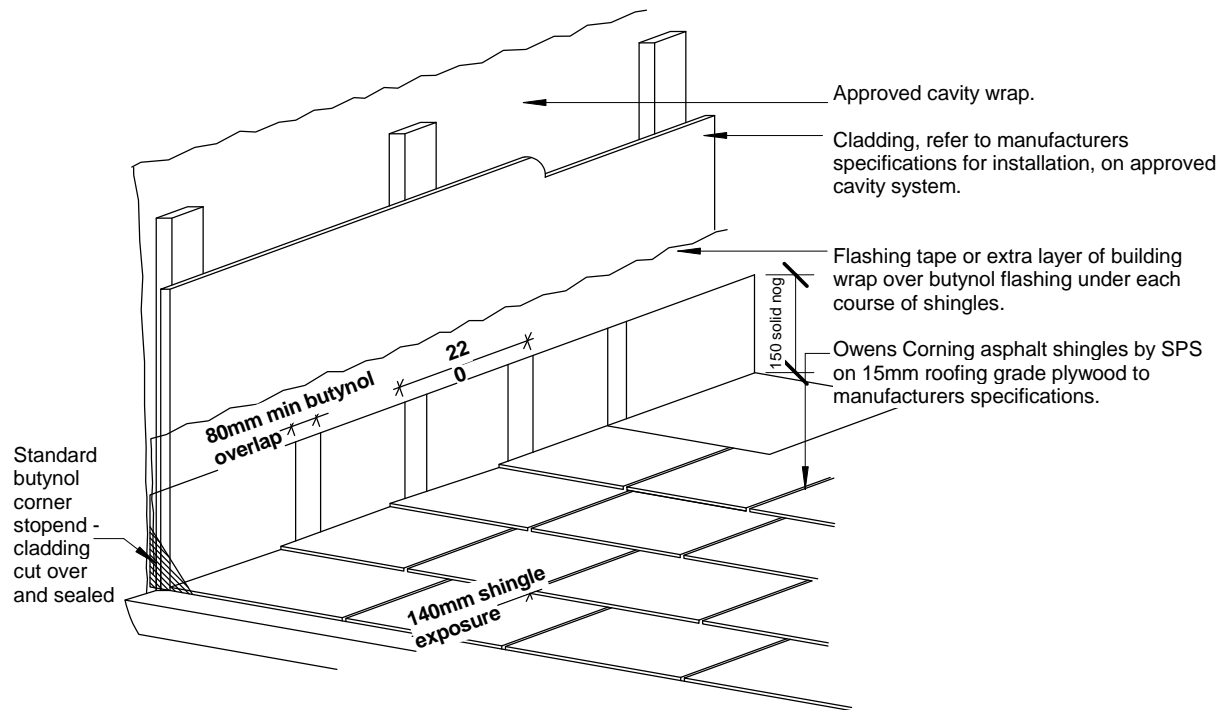

**Typical Owens Corning Shingle Gutter to Wall Junction**

**SHINGLE & SHAKE**  
SHINGLE ROOFING INSTALLERS

Shingle and Shake Ltd  
PO Box 101 760, North Shore Auckland  
16A Parkhead Place, Rosedale, North Shore  
Auckland, New Zealand  
Ph: 64 9 270 2690  
Web: [www.shingleandshake.co.nz](http://www.shingleandshake.co.nz)

**Gutter to wall junction**

Project number	<b>001</b>
Date	
Drawn by	
Checked by	
Scale	1 : 5

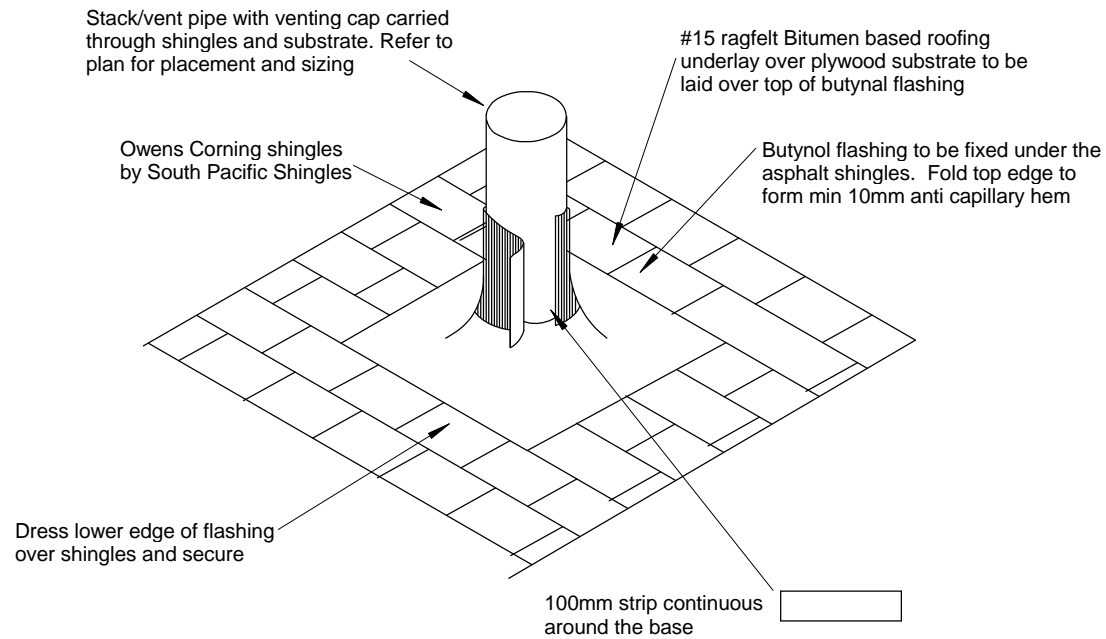

### Pipe Penetration

**SHINGLE & SHAKE**  
SHINGLE ROOFING INSTALLERS

Shingle and Shake Ltd  
PO Box 101 760, North Shore Auckland  
16A Parkhead Place, Rosedale, North Shore  
Auckland, New Zealand  
Ph: 64 9 270 2690  
Web: [www.shingleandshake.co.nz](http://www.shingleandshake.co.nz)

pipe penetration

Project number	001
Date	
Drawn by	
Checked by	Scale

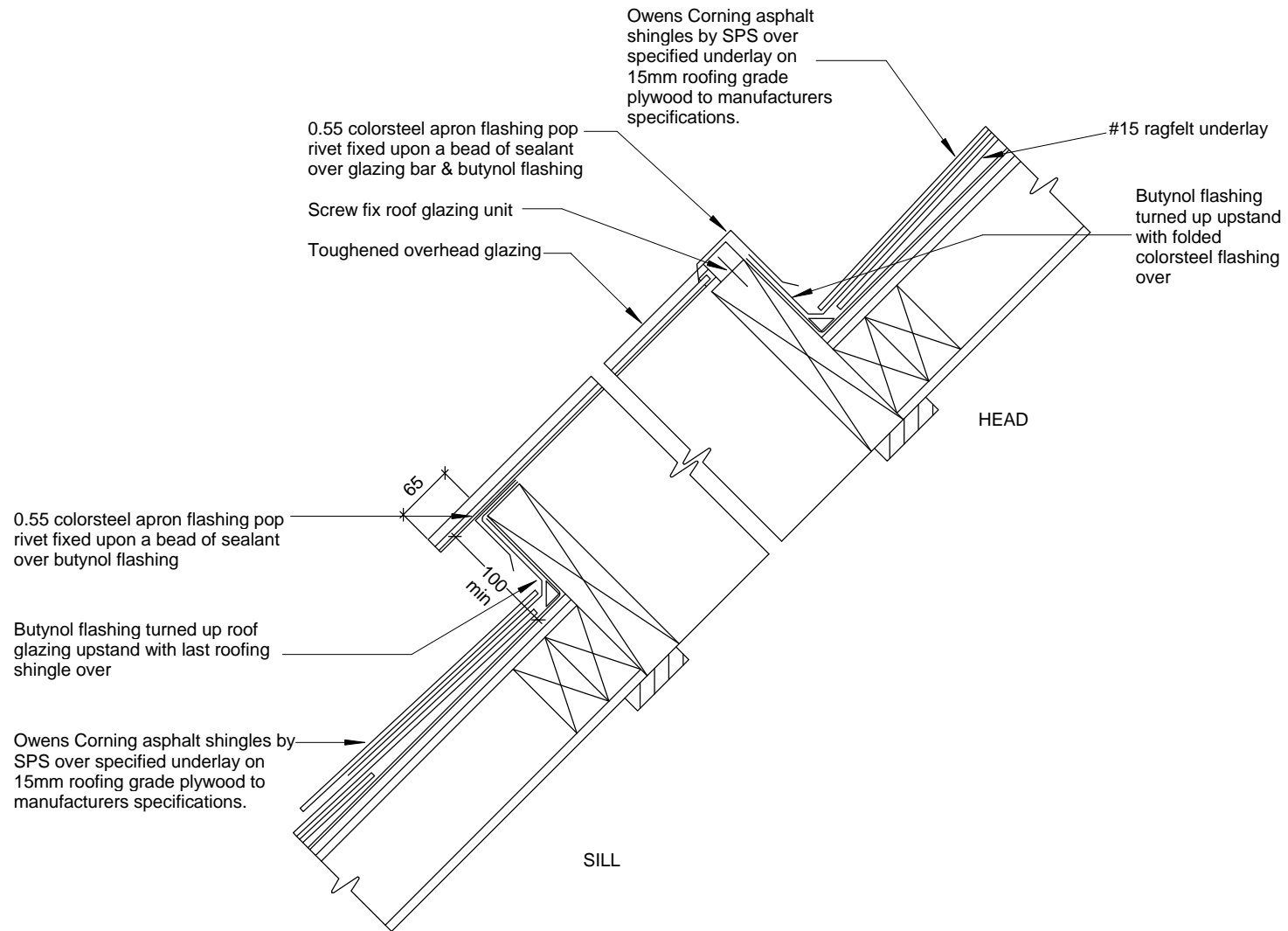

**Owens Corning roof to skylight head and sill detail**

**SHINGLE & SHAKE**  
SHINGLE ROOFING INSTALLERS

Shingle and Shake Ltd  
PO Box 101 760, North Shore Auckland  
16A Parkhead Place, Rosedale, North Shore  
Auckland, New Zealand  
Ph: 64 9 270 2690  
Web: [www.shingleandshake.co.nz](http://www.shingleandshake.co.nz)

Roof to skylight head and sill detail

Project number	001
Date	
Drawn by	
Checked by	
Scale	1 : 5