

**Timber Shingle/Shake Cross Section**

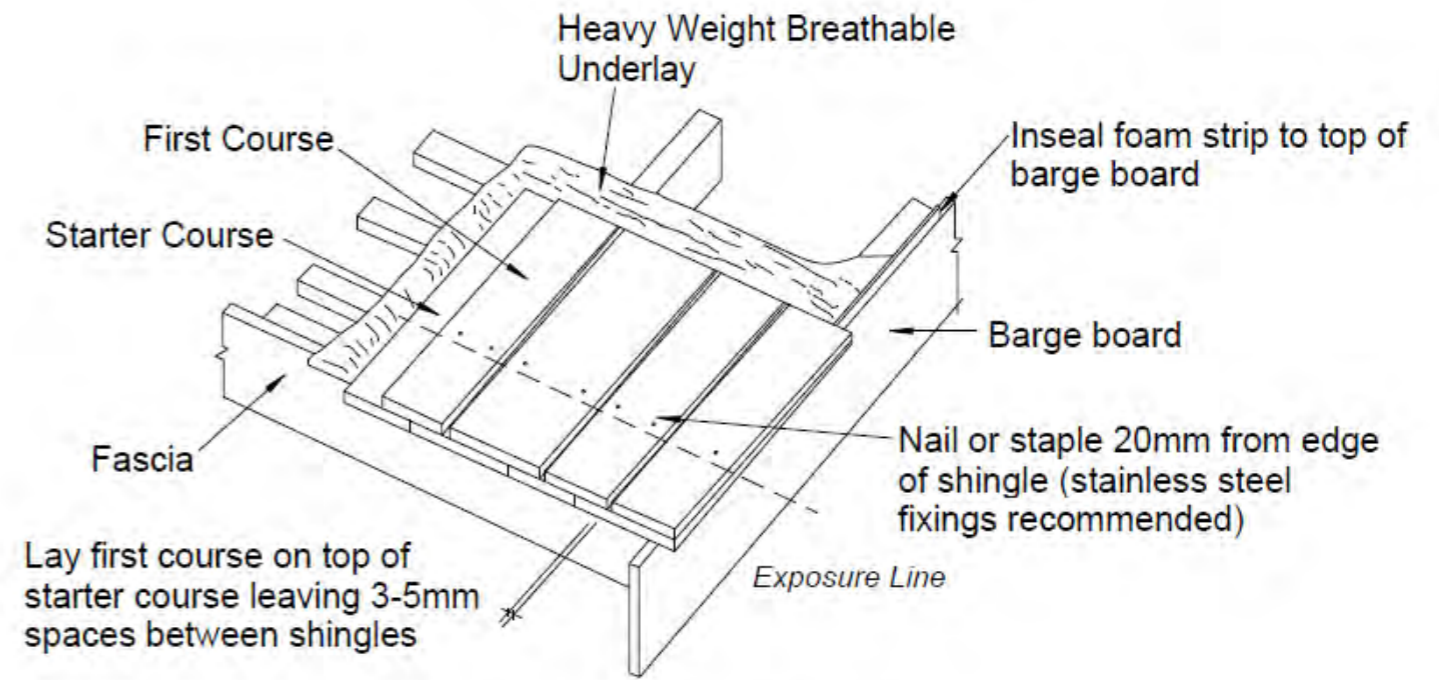

**Timber Shingle/Shake First Course**

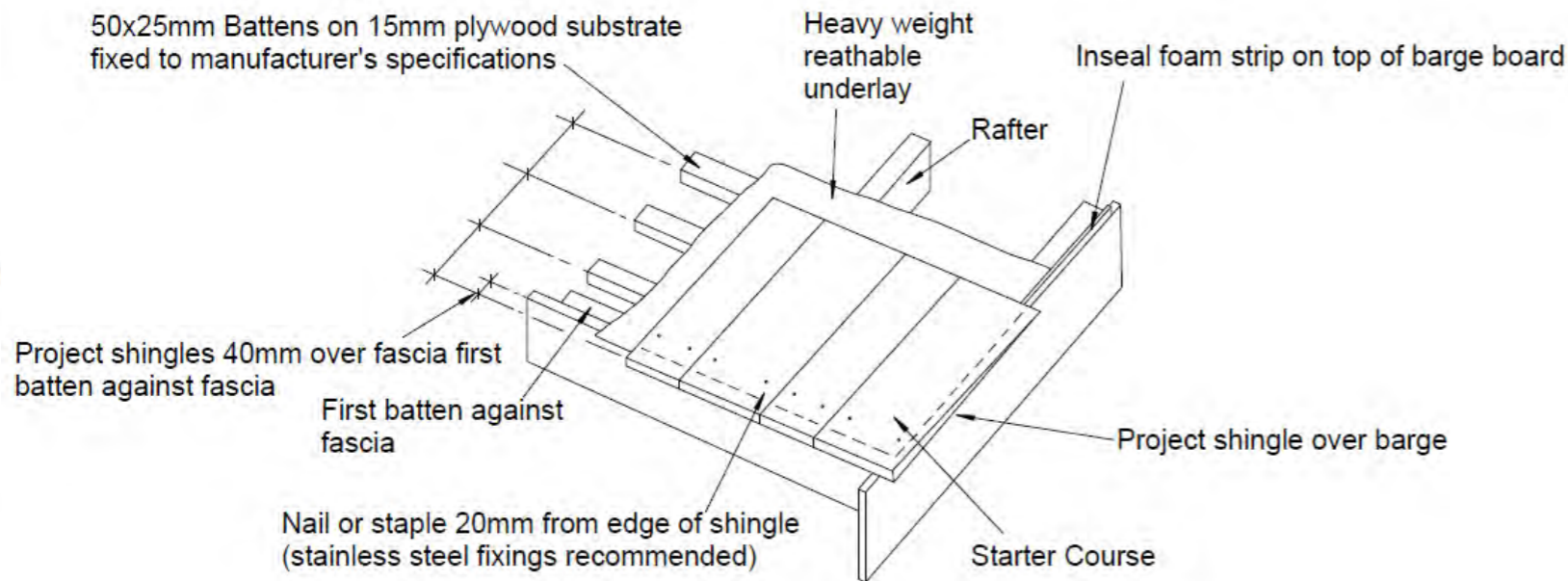

**Starter Course Shingles To Be Laid Without Spaces**

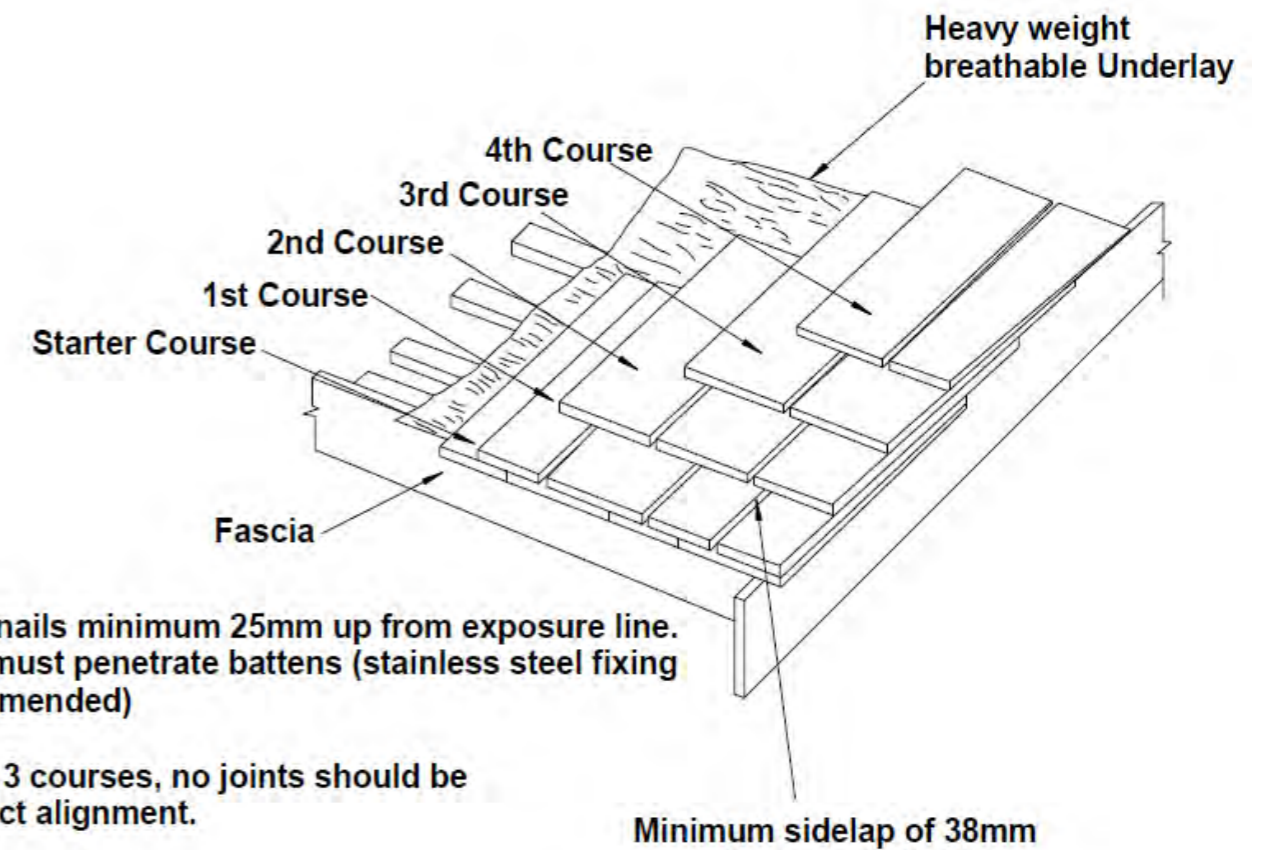

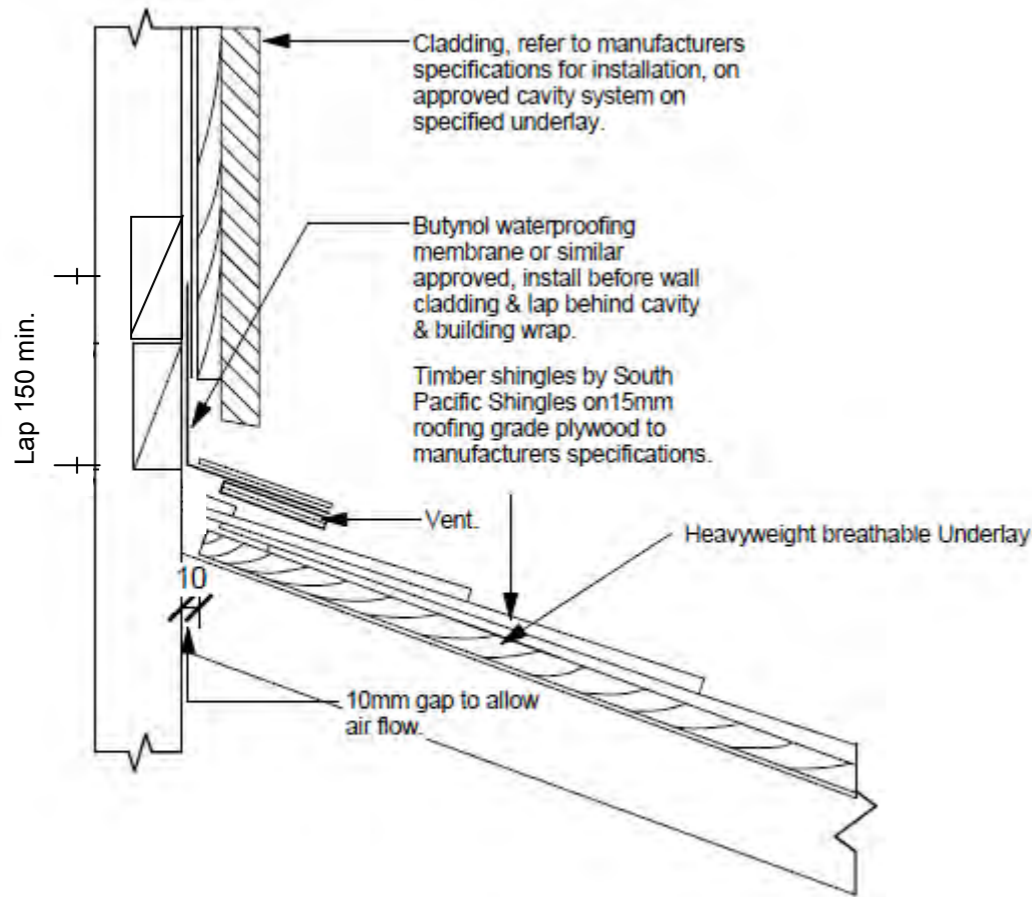

**Typical Shingle Vented Apron Flashing - Roof to Wall**

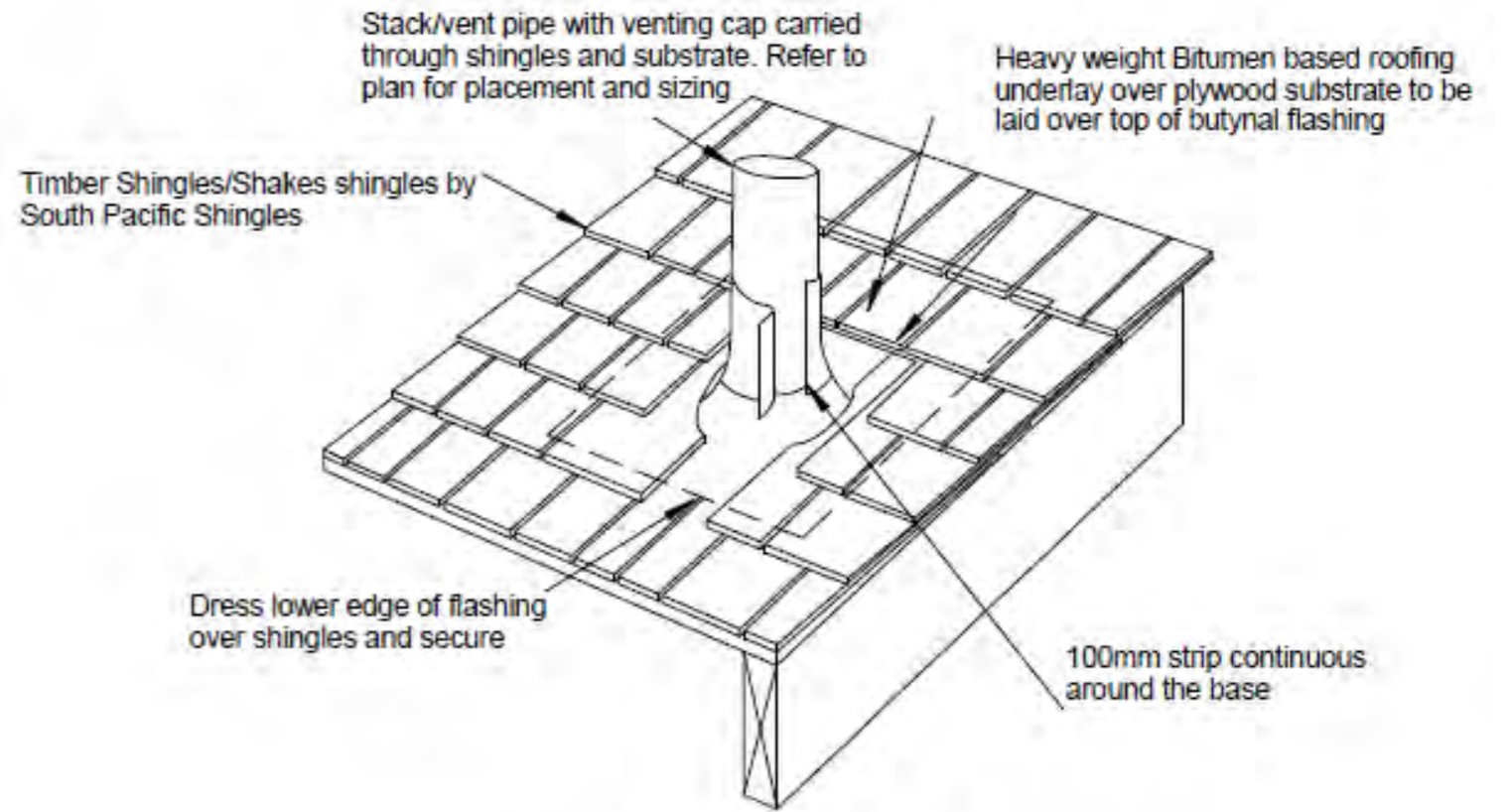

**Timber Shingle/Shake Pipe Penetration**

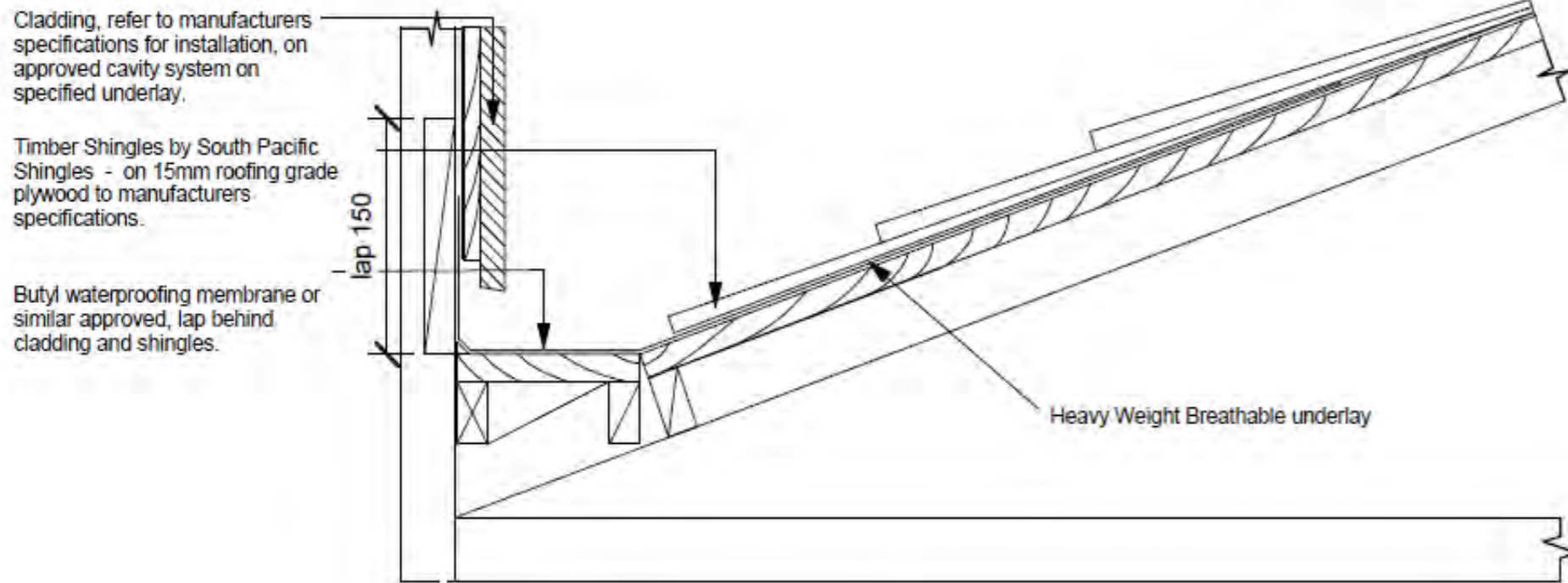

**Timber Shingles Chimney Flashing Detail**

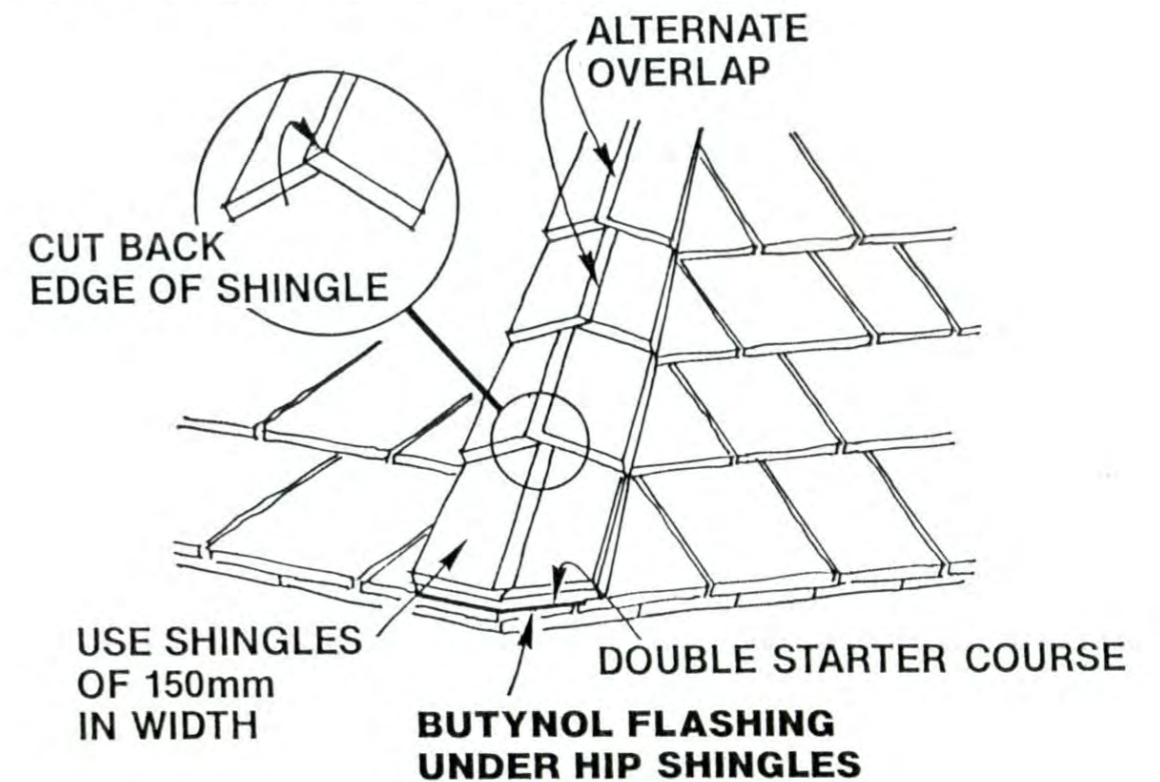

# Roof to Wall Detail

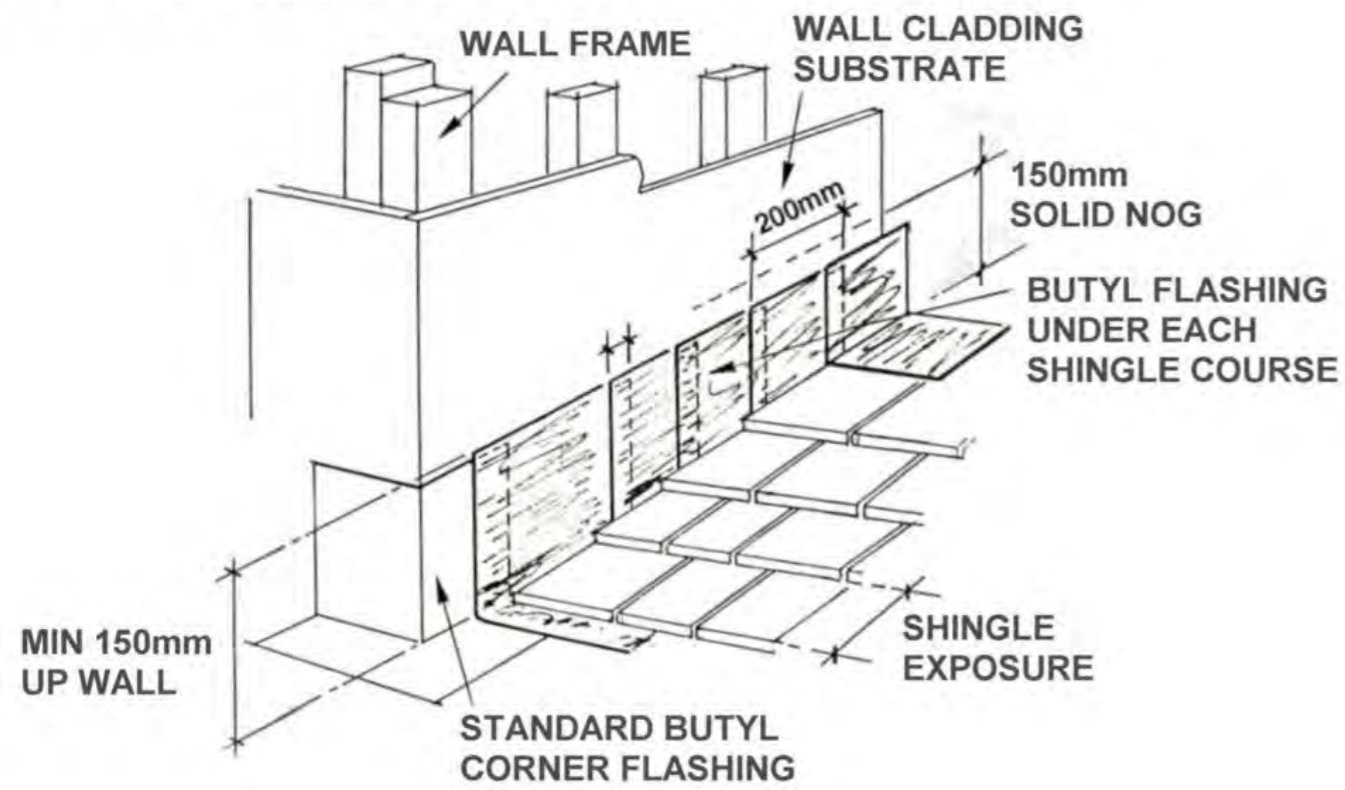

South Pacific Shingles -Timber shingles on heavy weight bituminous bldg paper

Plywood or battens to manufacturers specifications ( If required to approved cavity system on specified underlay

South Pacific Shingles -Timber shingles on heavy weight bituminous bldg paper

Plywood or battens to manufacturers specifications ( If required to approved cavity system on specified underlay

# Interlace Underlay Method

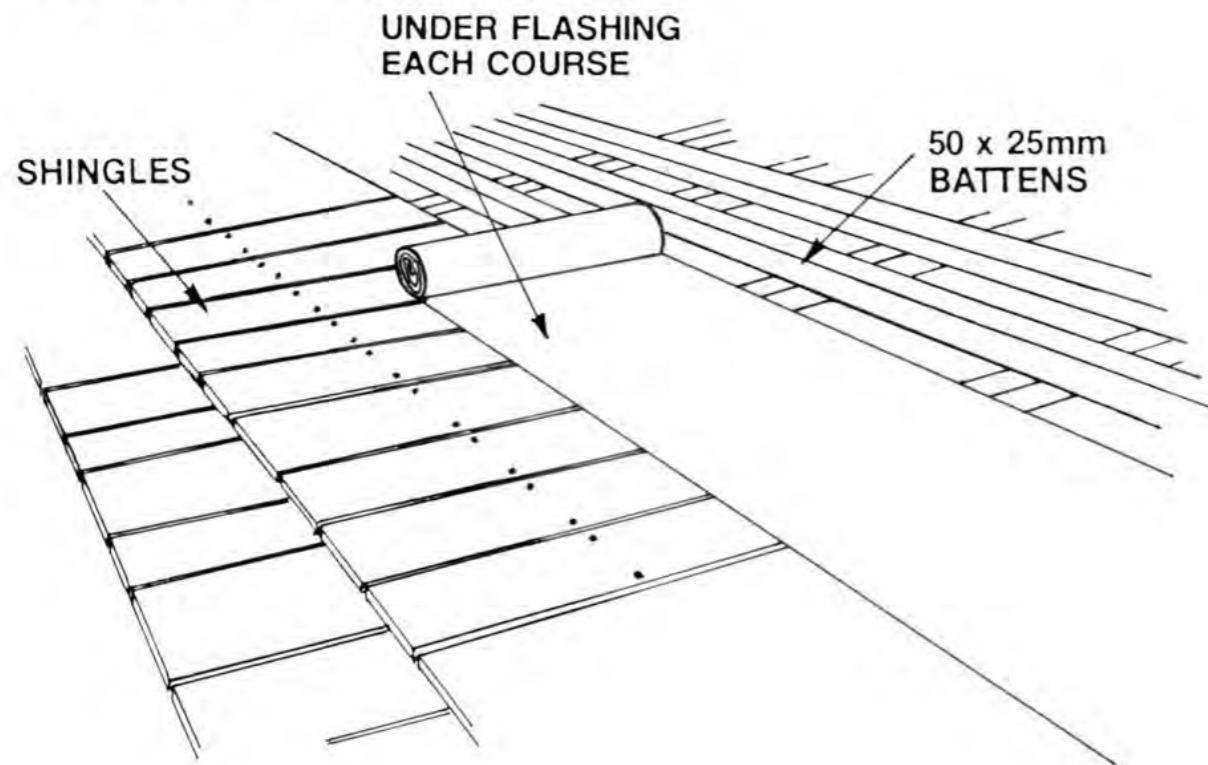

Chase copper flashing or similar into jamb

6x6 groove

South Pacific Shingles - timber shingles on heavy weight bituminous bldg paper on plywood or battens to manufacturers specifications

# Typical Wall Detail

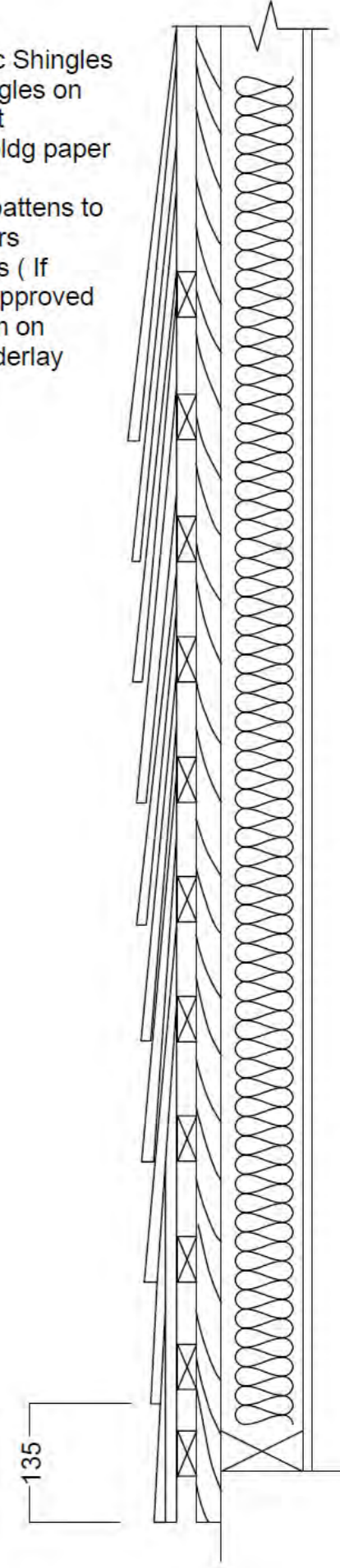
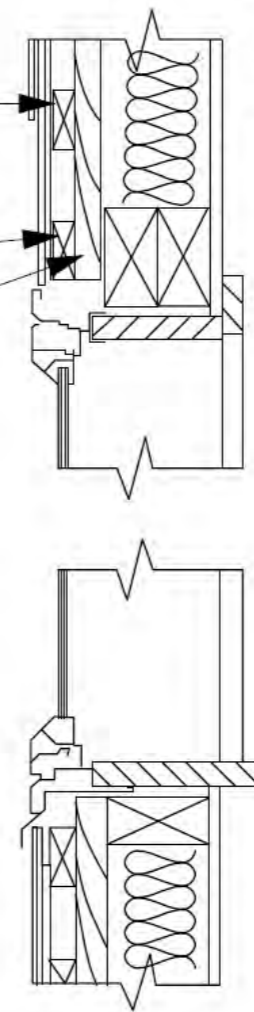

## 1. STARTER COURSE

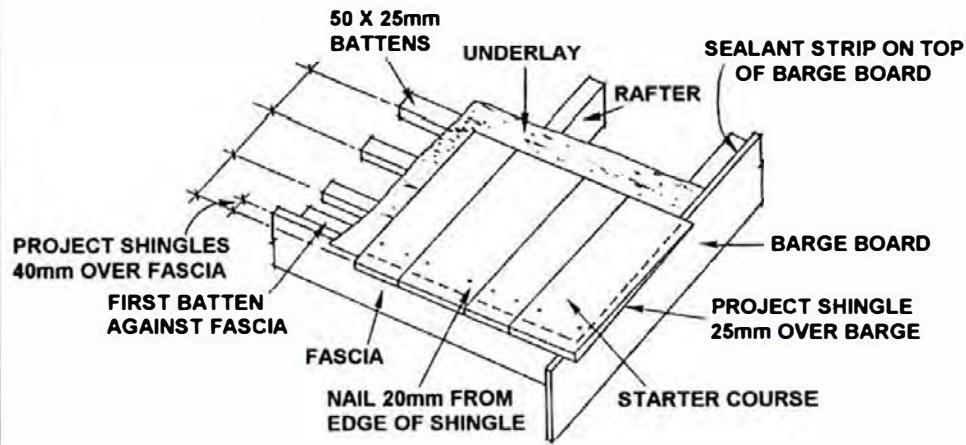

STARTER COURSE SHINGLES TO BE LAYED WITHOUT SPACES

## 2. FIRST COURSE

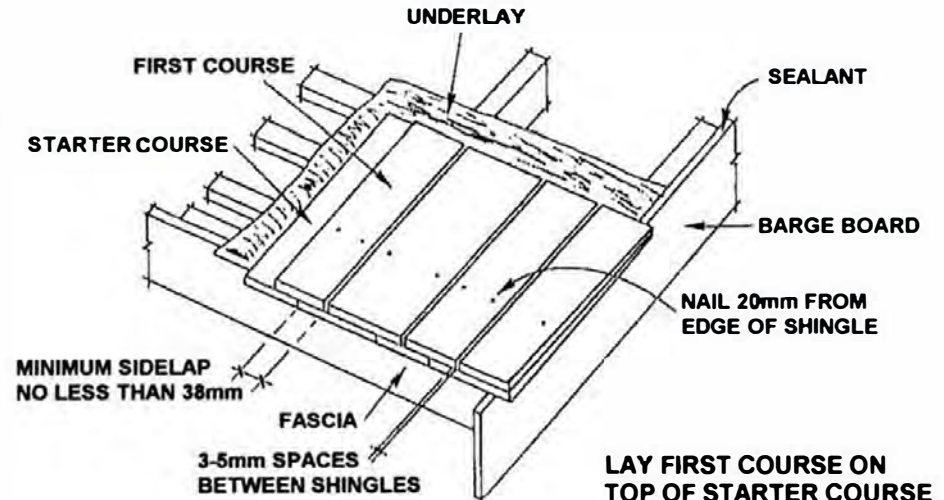

LAY FIRST COURSE ON TOP OF STARTER COURSE LEAVING 3-5mm SPACES BETWEEN SHINGLES

## 3. SHINGLE COURSES

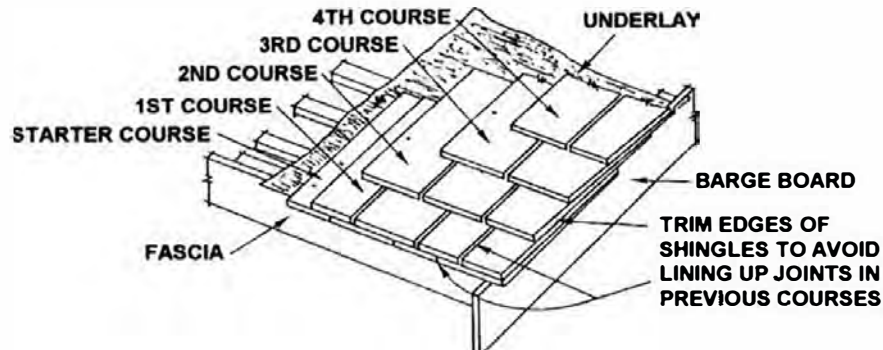

PLACE NAILS 25mm UP FROM EXPOSURE LINE. NAILS MUST PENETRATE BATTENS.

IN ANY 3 COURSES, NO JOINTS SHOULD BE IN DIRECT ALIGNMENT.

## 4. CROSS SECTION

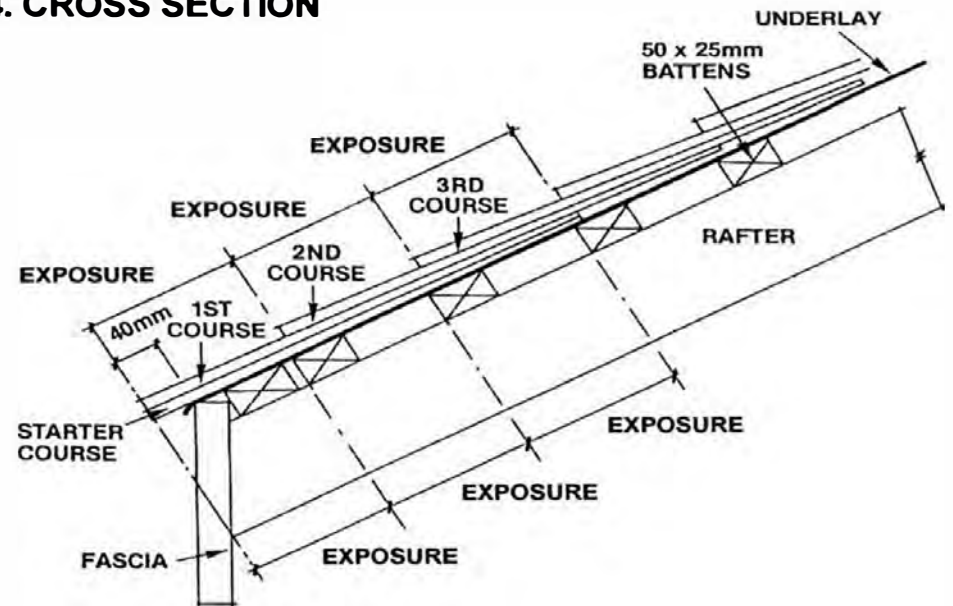

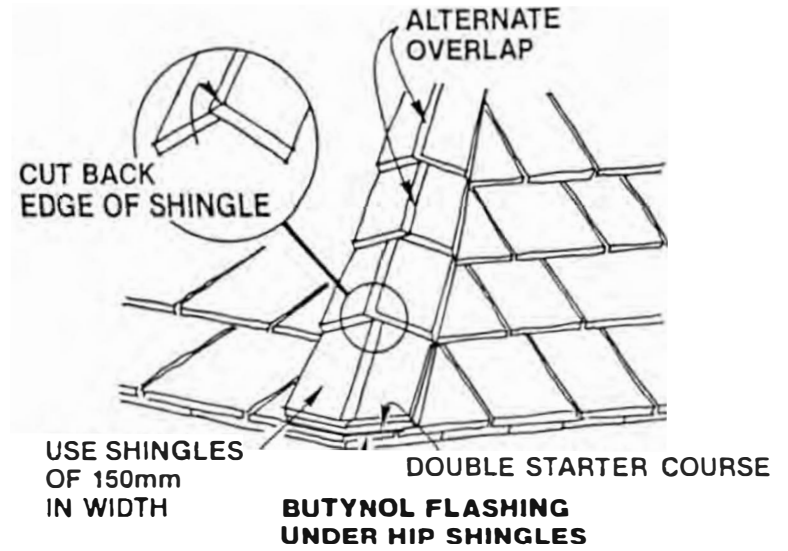
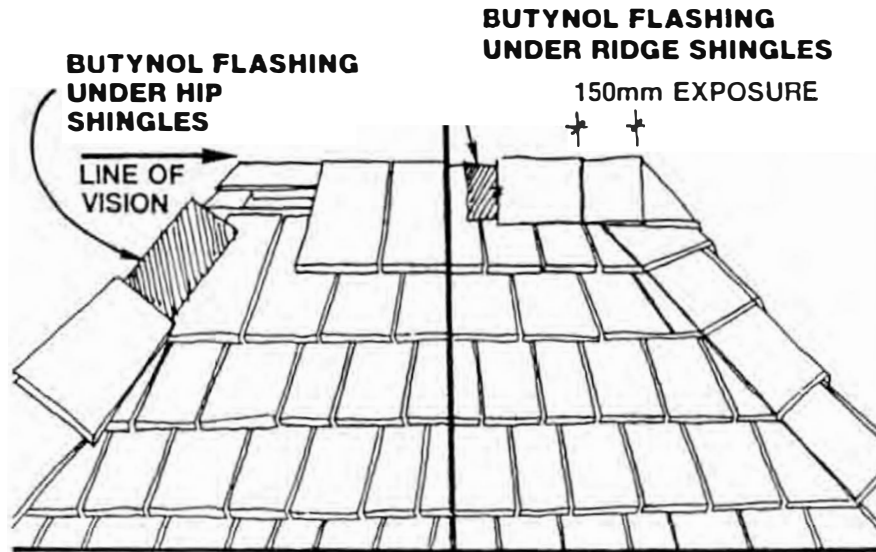

**TYPICAL DETAIL EXTERNAL CORNER**

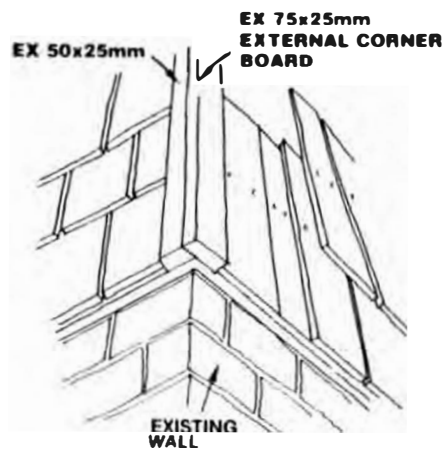

**TYPICAL DETAIL INTERNAL CORNER**

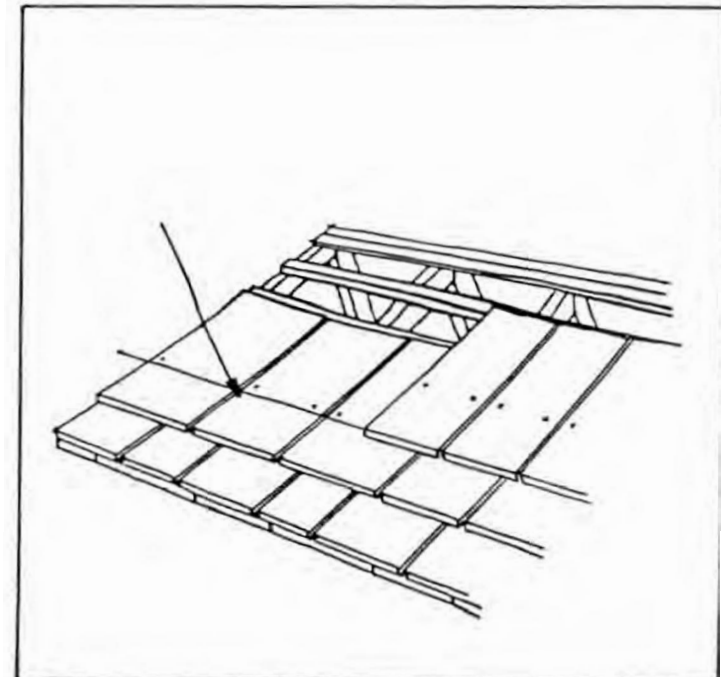
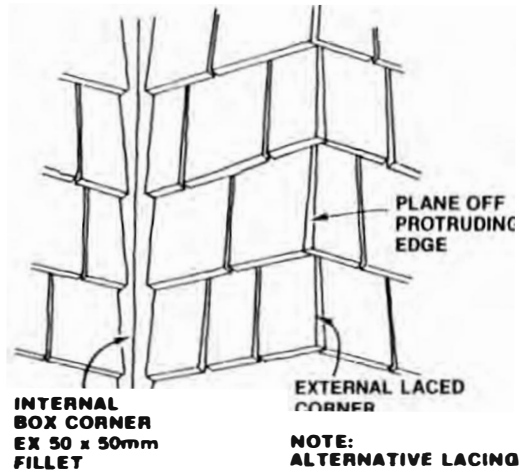

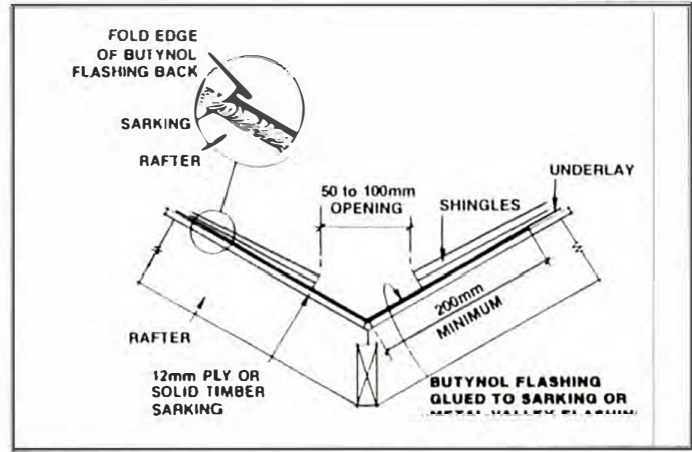
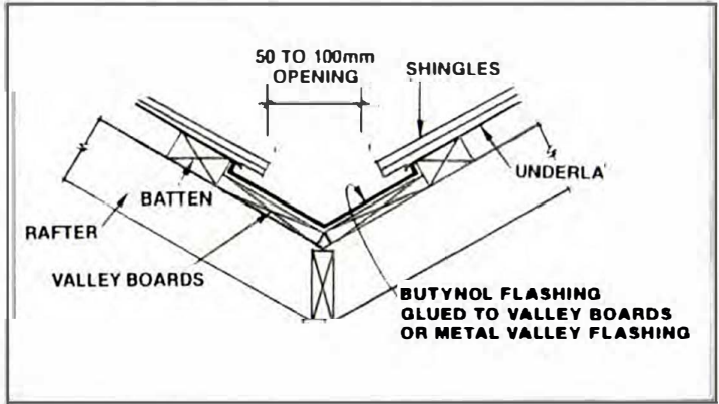
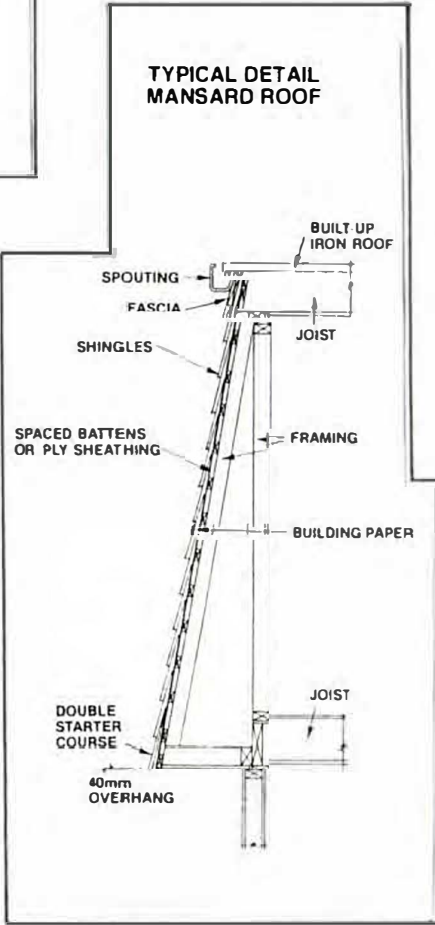
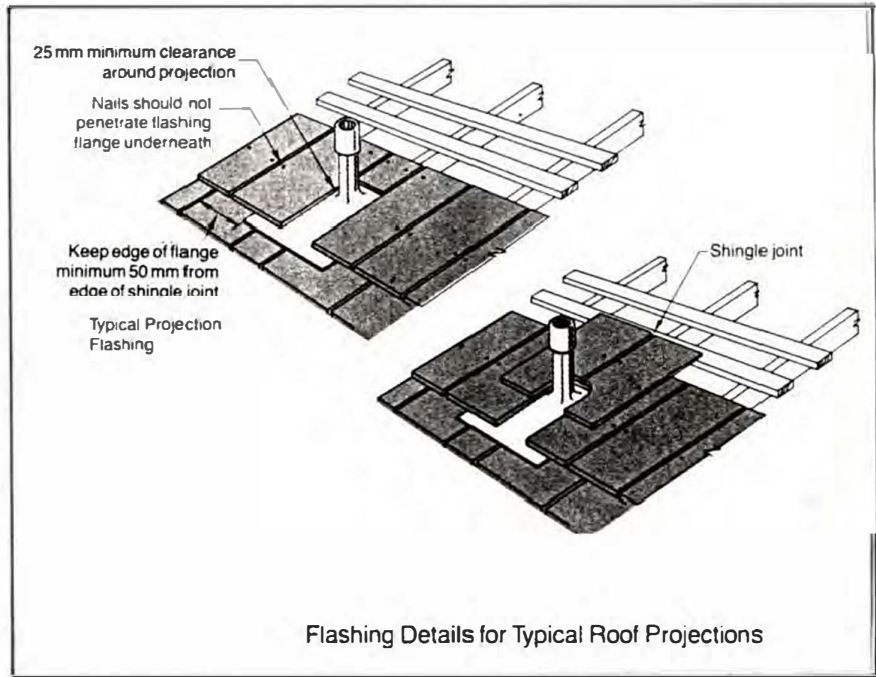
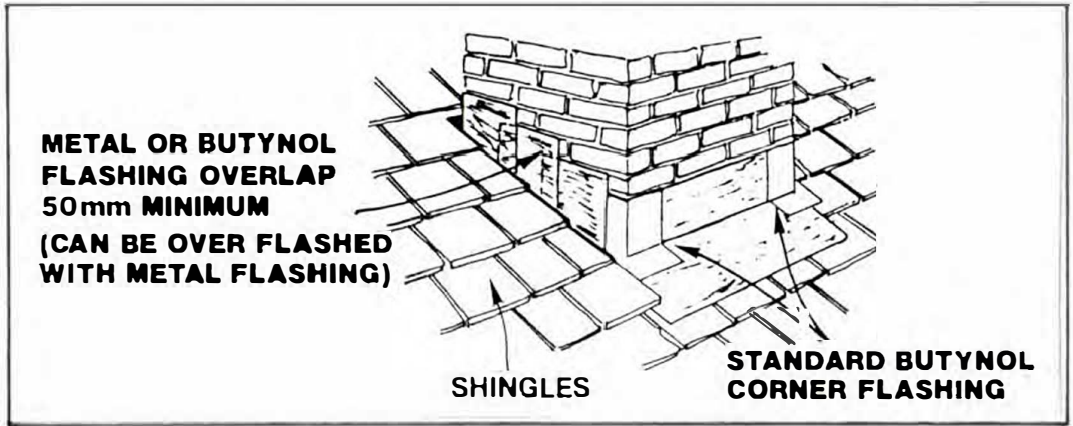
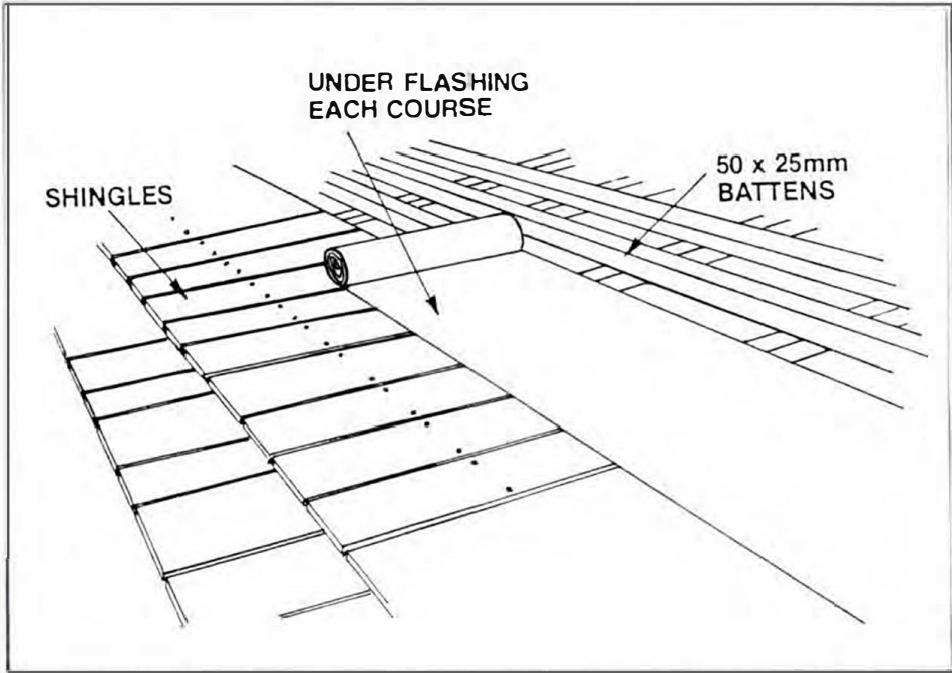

### GABLE ENDS TYPICAL EAVE DETAIL

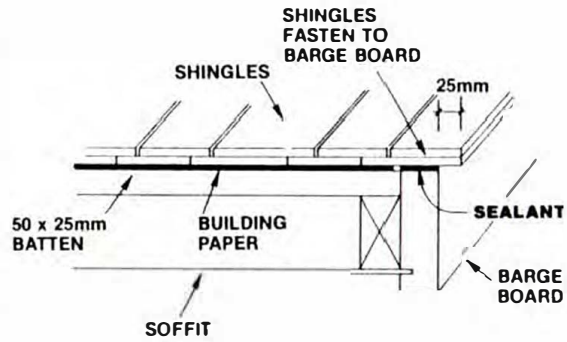

### TYPICAL WALL DETAIL

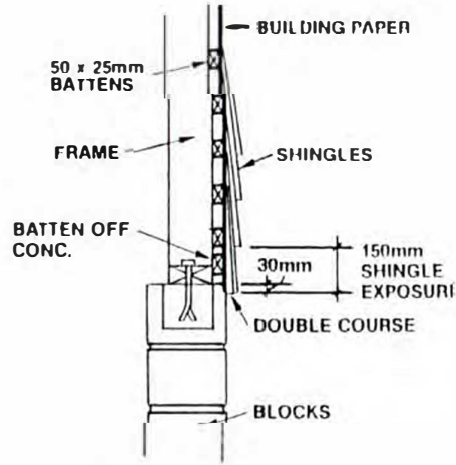

### GABLE ENDS CONCEALED GUTTER EAVE DETAIL

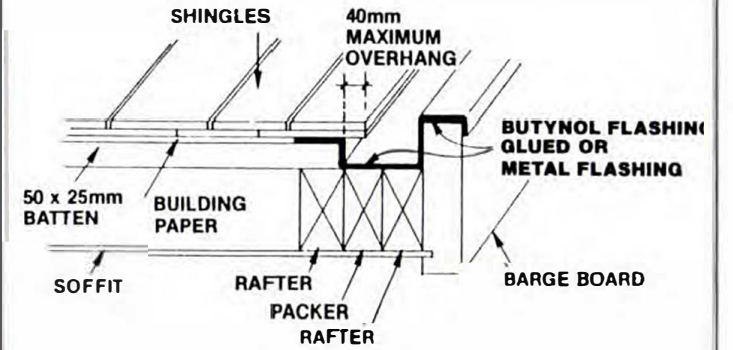

### TYPICAL FLASHING DETAIL WALL TO ROOF

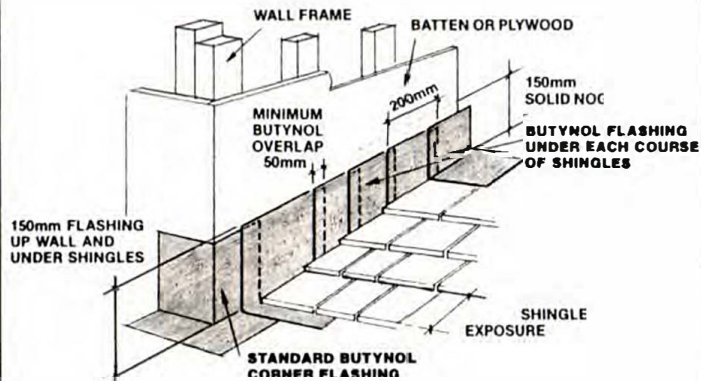

### TYPICAL FLASHING DETAIL WALL TO ROOF

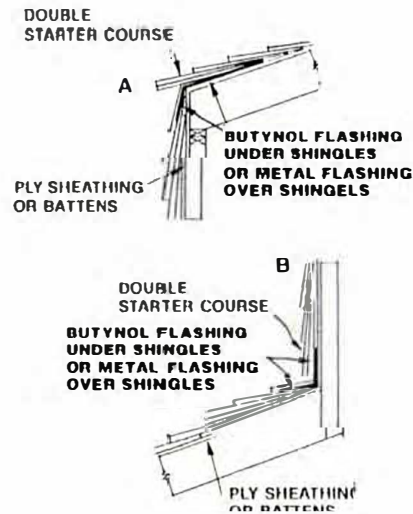

### CONCEALED GUTTER DETAIL WALL TO ROOF JUNCTION

